

ELEVAÇÃO

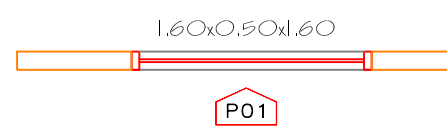

PLANTA BAIXA
PAREDE 01
S=8,38M²

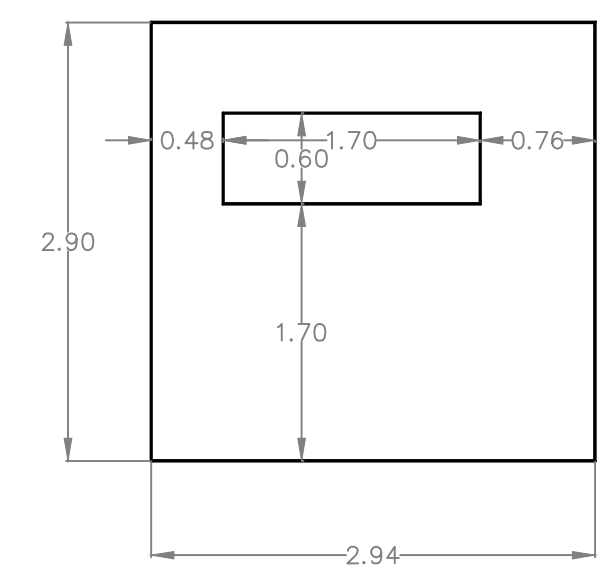

ELEVAÇÃO

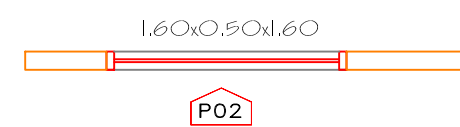

PLANTA BAIXA
PAREDE 02
S=8,52M²

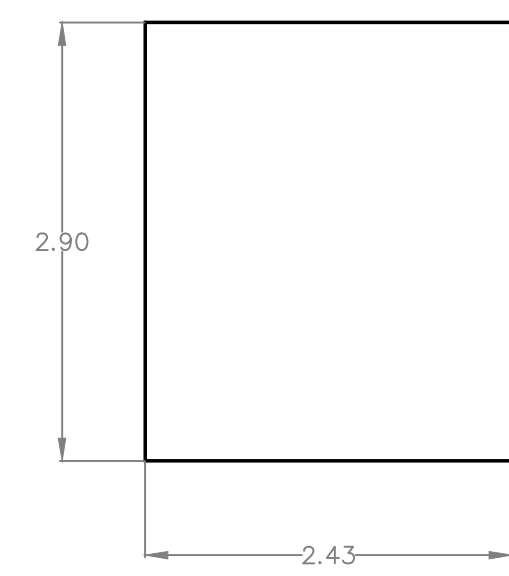

ELEVAÇÃO

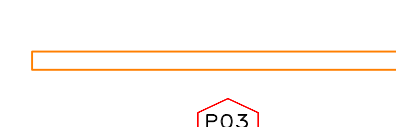

PLANTA BAIXA
PAREDE 03
S=8,04M²

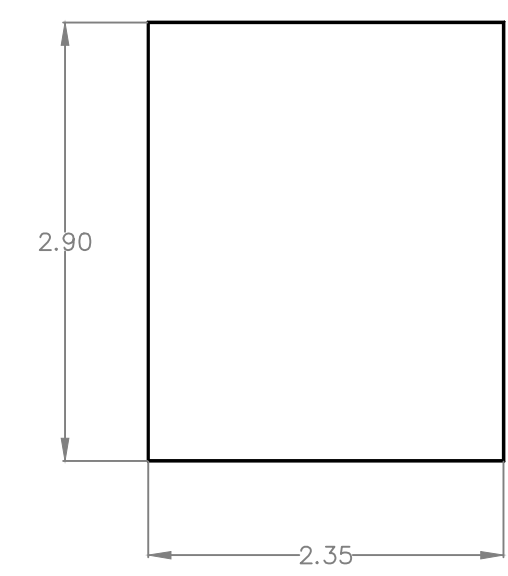

ELEVAÇÃO

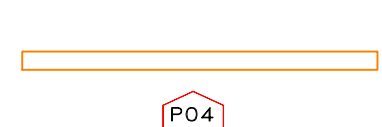

PLANTA BAIXA
PAREDE 04
S=6,81M²

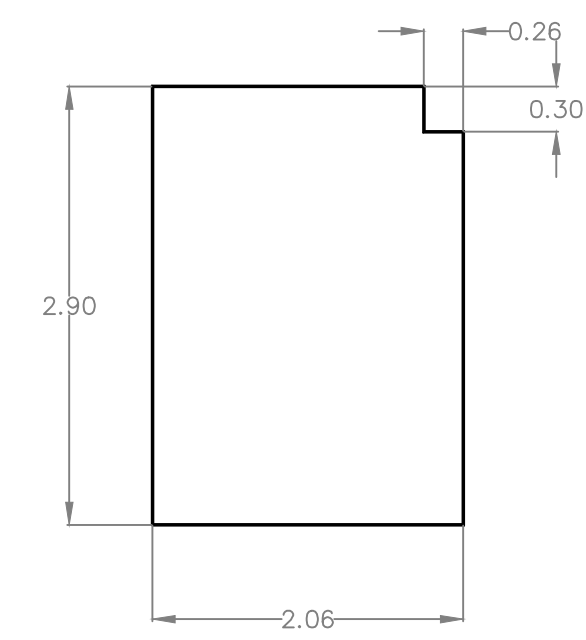

ELEVAÇÃO



PLANTA BAIXA
PAREDE 05
S=5,97M²

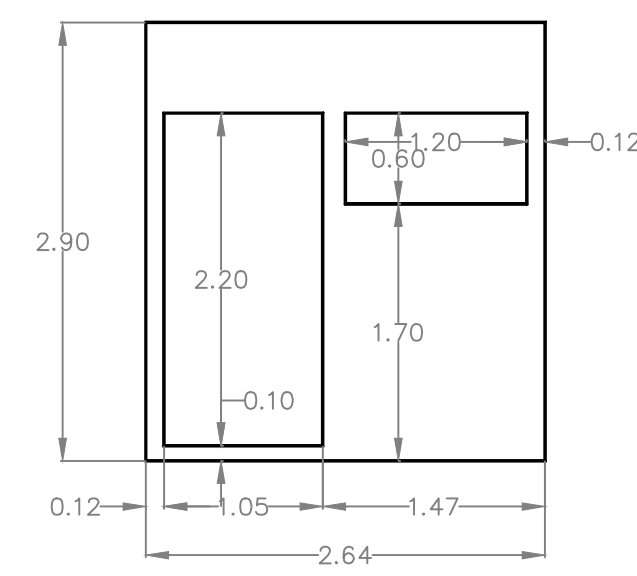

ELEVAÇÃO

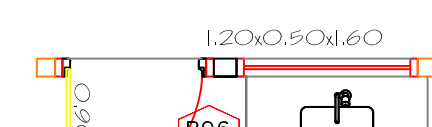

PLANTA BAIXA
PAREDE 06
S=7,65M²

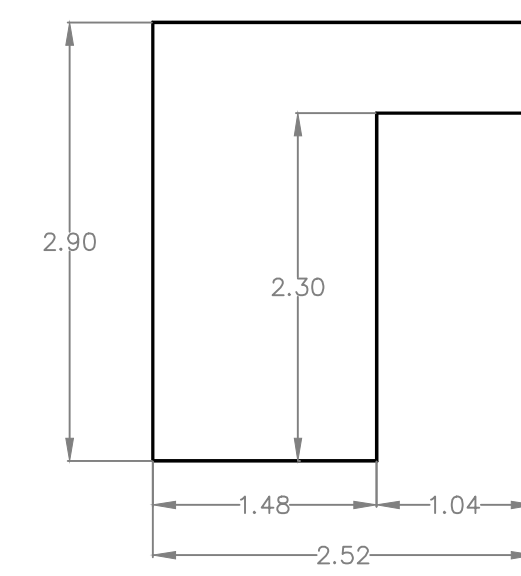

ELEVAÇÃO



PLANTA BAIXA
PAREDE 07
S=7,30M²

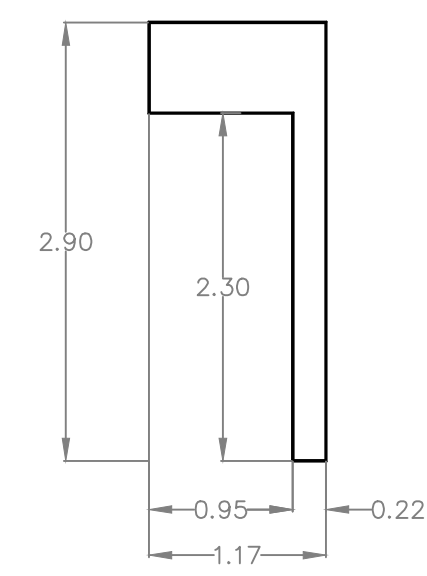

ELEVAÇÃO

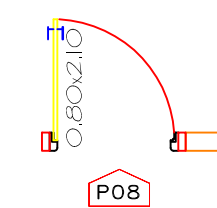

PLANTA BAIXA
PAREDE 08
S=3,39M²

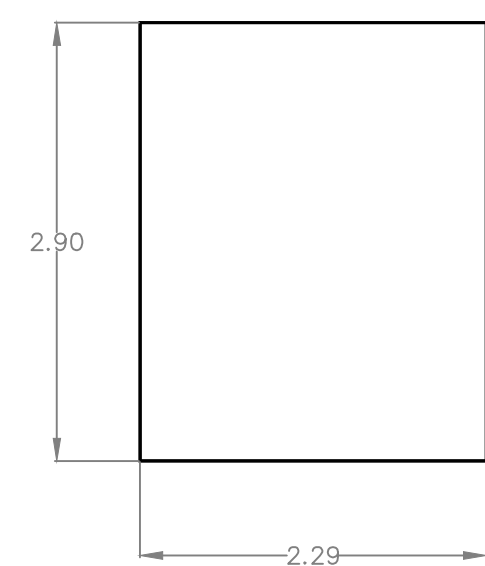

ELEVAÇÃO



PLANTA BAIXA
PAREDE 09
S=6,64M²

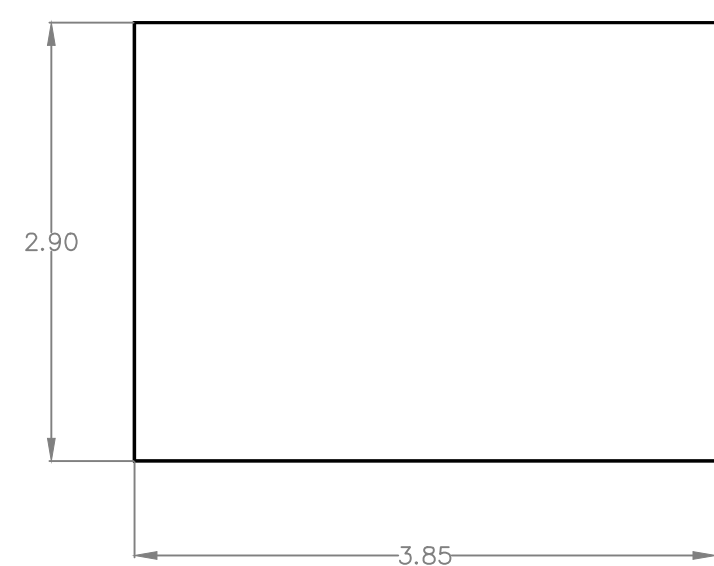

ELEVAÇÃO

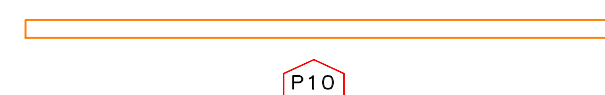

PLANTA BAIXA
PAREDE 10
S=11,16M²

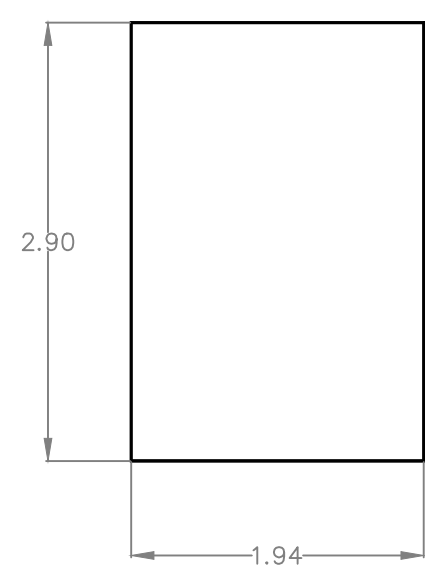

ELEVAÇÃO



PLANTA BAIXA
PAREDE 11
S=5,62M²

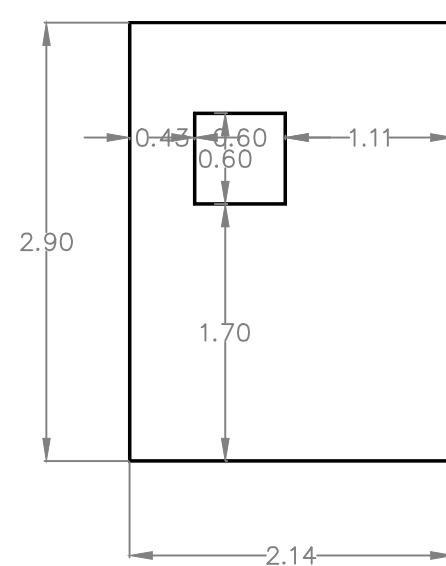

ELEVAÇÃO

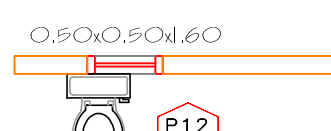

PLANTA BAIXA
PAREDE 12
S=6,20M²

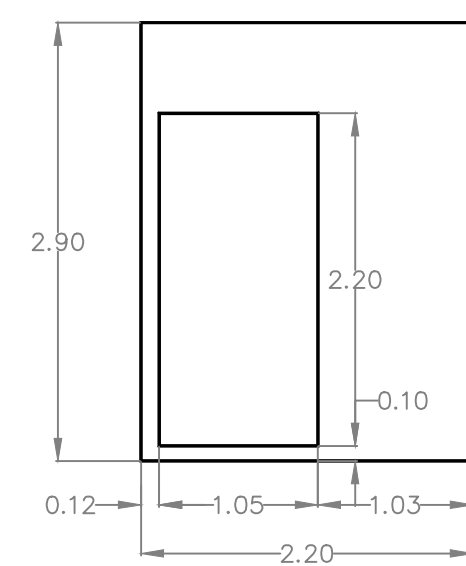

ELEVAÇÃO



PLANTA BAIXA
PAREDE 13
S=6,38M²

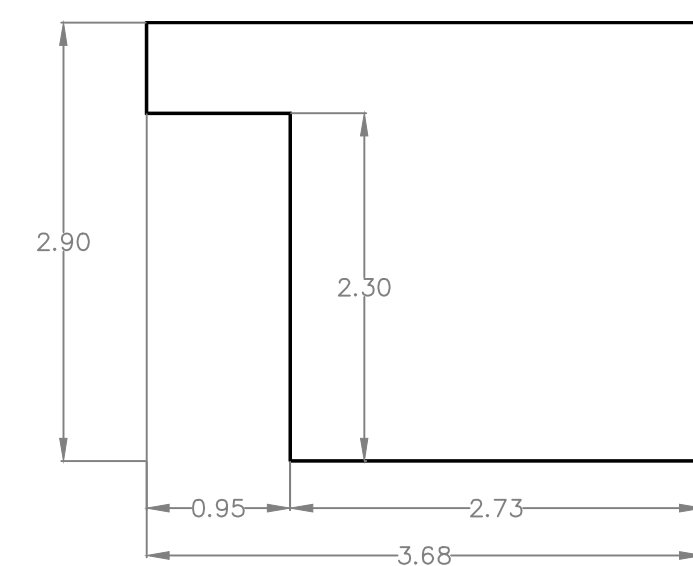

ELEVAÇÃO

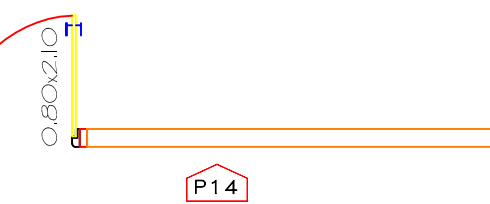

PLANTA BAIXA
PAREDE 14
S=10,67M²

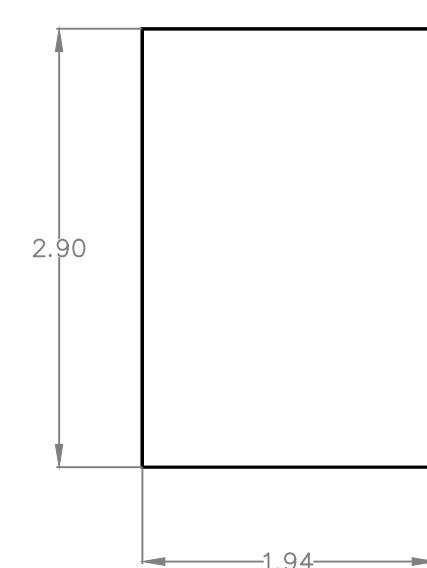

ELEVAÇÃO



PLANTA BAIXA
PAREDE 15
S=5,62M²

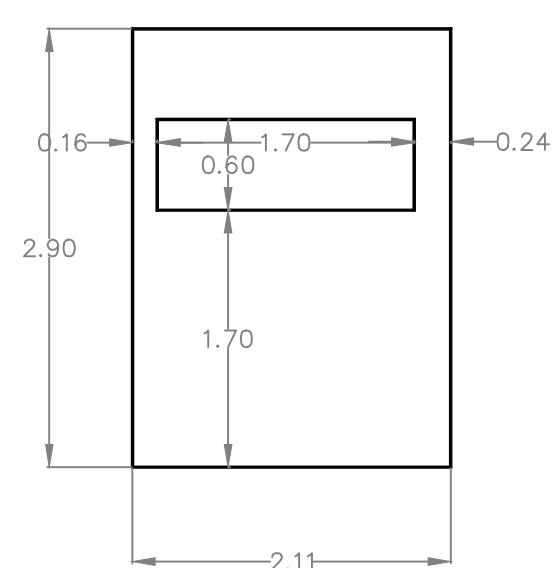

ELEVAÇÃO

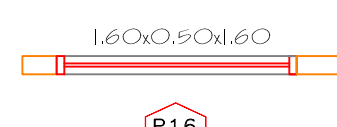

PLANTA BAIXA
PAREDE 16
S=6,11M²

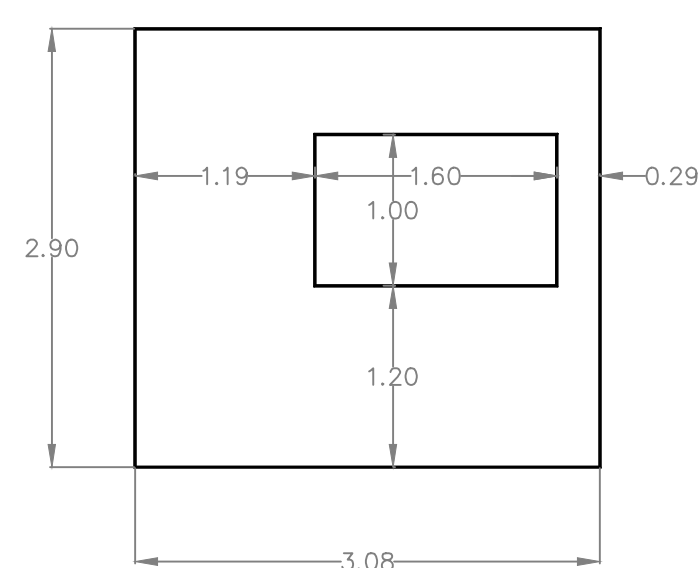

ELEVAÇÃO

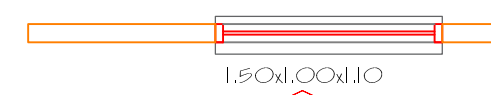

PLANTA BAIXA
PAREDE 17
S=8,93M²

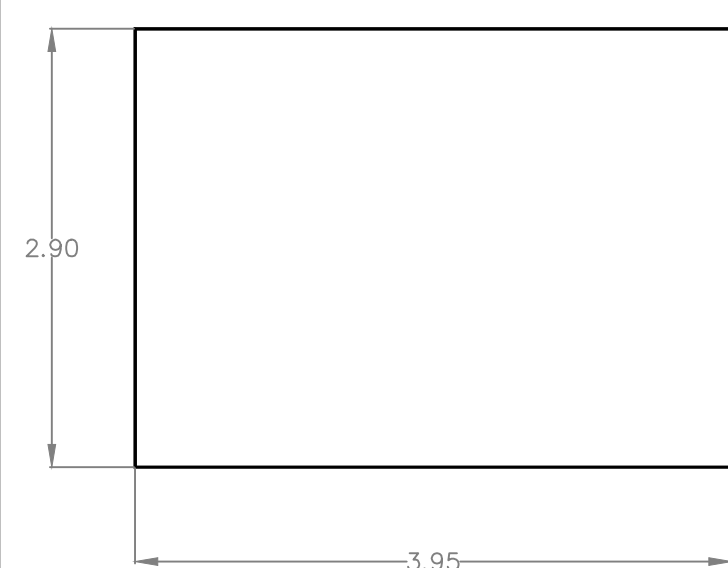

ELEVAÇÃO



PLANTA BAIXA
PAREDE 18
S=11,45M²

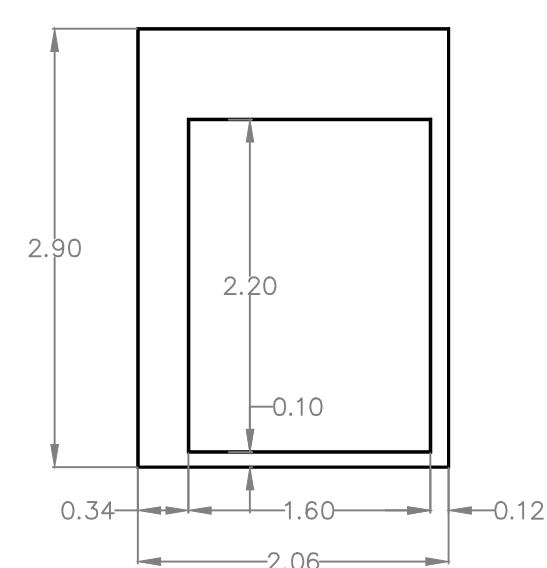

ELEVAÇÃO

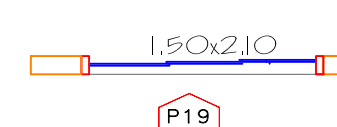

PLANTA BAIXA
PAREDE 19
S=5,97M²

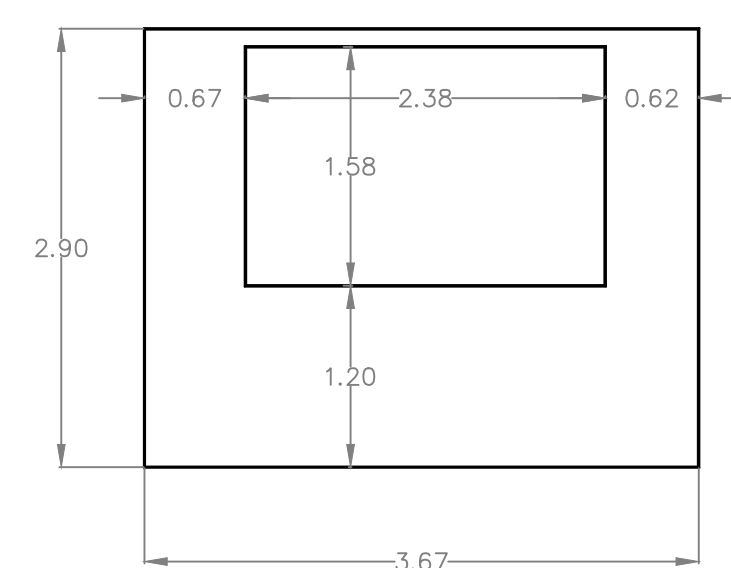

ELEVAÇÃO



PLANTA BAIXA
PAREDE 20
S=10,63M²



CONSOLIDANDO O FUTURO

Prefeitura Municipal de Anaurilândia - MS.

PROJETO CONSTRUÇÃO/PRE-MOLDADO - (PLANTA BAIXA PAREDES 01 ATÉ PAREDES 20).
Farmácia Popular de Anaurilândia-MS

DATA: Junho de 2024 ESCALA: Indicada FOLHA: 6-8 RRT: 14542346

PROPRIETÁRIO: Município de Anaurilândia-MS CNPJ: 03.575.727/0001-95

LOCAL DA OBRA: Rua: Dom Pedro II - Lote 5 / Quadra 7 BAIRRO: Centro CEP: 79770-000

CIDADE: Anaurilândia - MS PROJETO/Glauco Ricci Lopes

SITUAÇÃO S/ ESCALA

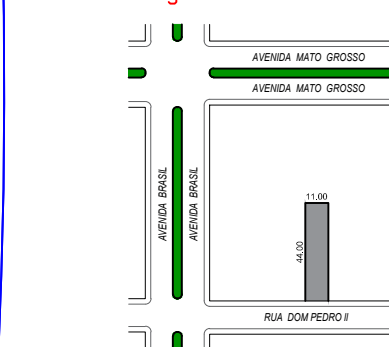

MUNICÍPIO DE ANAURILÂNDIA-MS
PREFEITO MUNICIPAL:
Edson Stefano Takazono

ÁREA

Total Obra.....60,94 m²
Terreno.....484,00 m²
Área Livre.....423,06 m²

SECRETARIA MUNICIPAL DE OBRAS,
DEFESA CIVIL, TRANSPORTE E PROJETOS.
Jeovan Nogueira de Lima
Arquiteto Urbanista: CAU BR - A97459-5

APROVAÇÃO